

2 EXISTING PHOTOS
SCALE: NOT TO SCALE

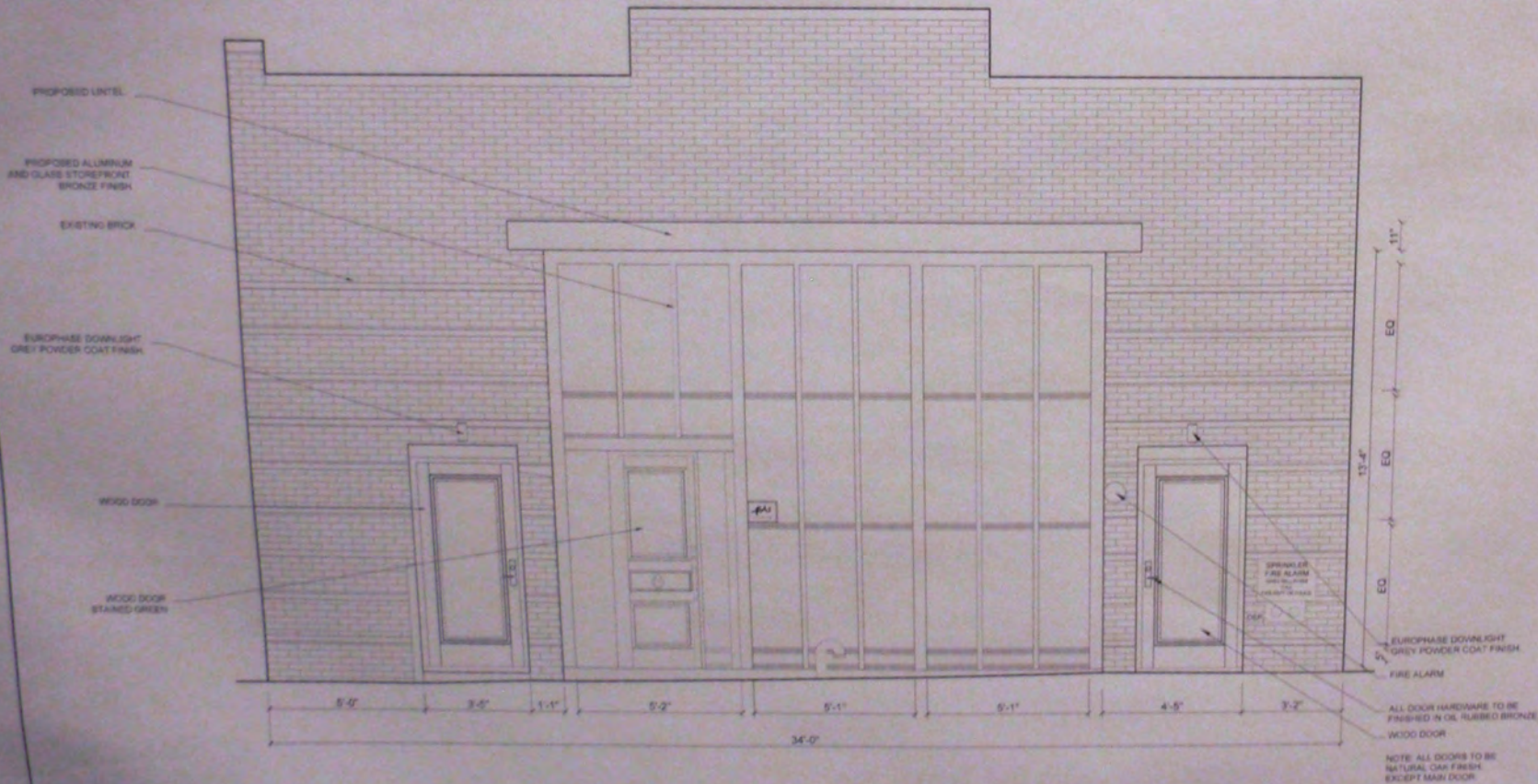

1 EXISTING ELEVATIONS
SCALE: 1/4" = 1'-0"

JULY 2012
MAY 2011
APRIL 2011
ISSUE DATES

RENOVATION
@
28 7TH AVENUE
NEW YORK, N.Y. 10014

SWA
100 WALL ST., 10TH FLOOR
NEW YORK, N.Y. 10038
100 E. MAIN STREET
HUNTINGTON, N.Y.

18

A-5

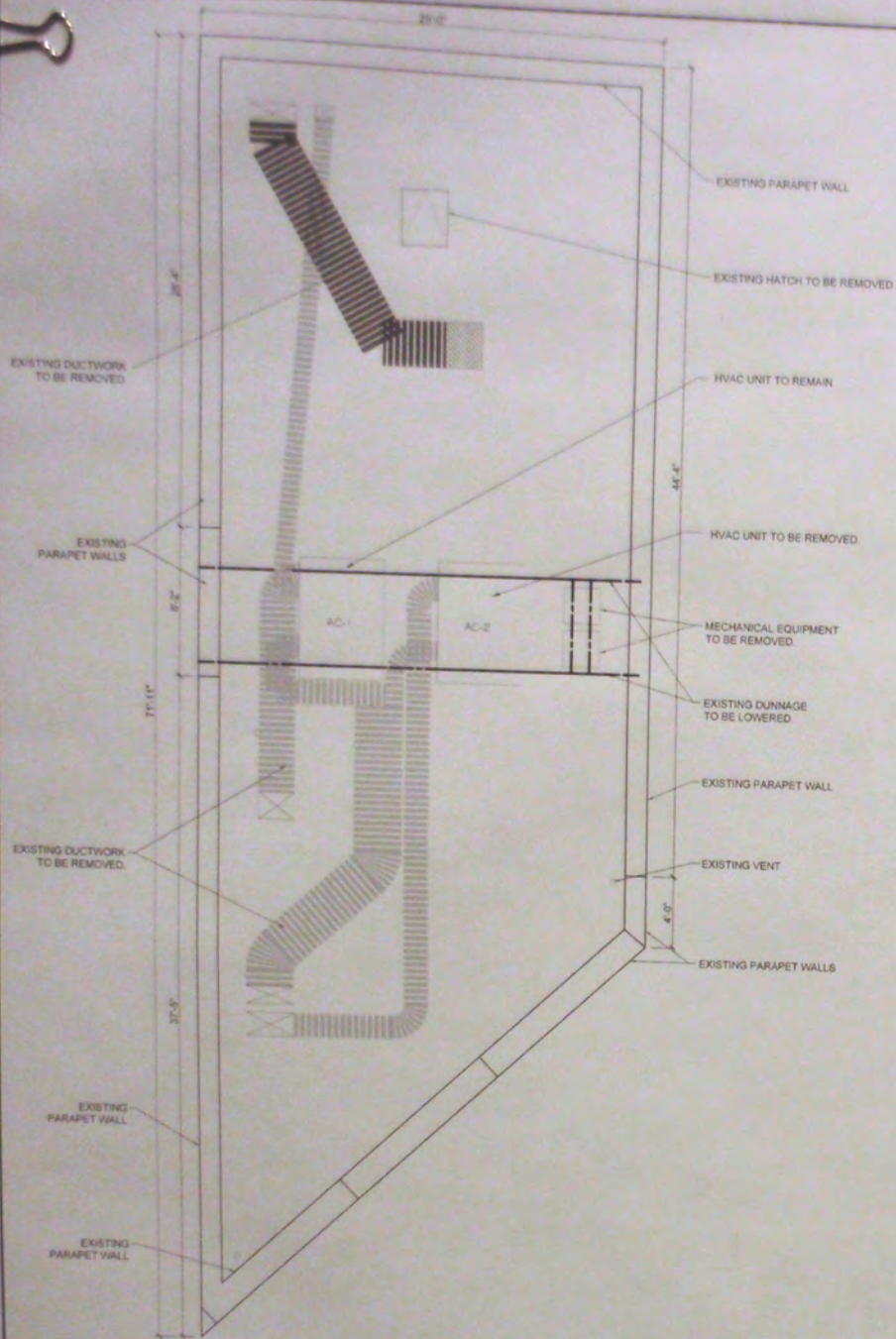

① PREVIOUS EXISTING ROOF
SCALE: 1/4" = 1'-0"

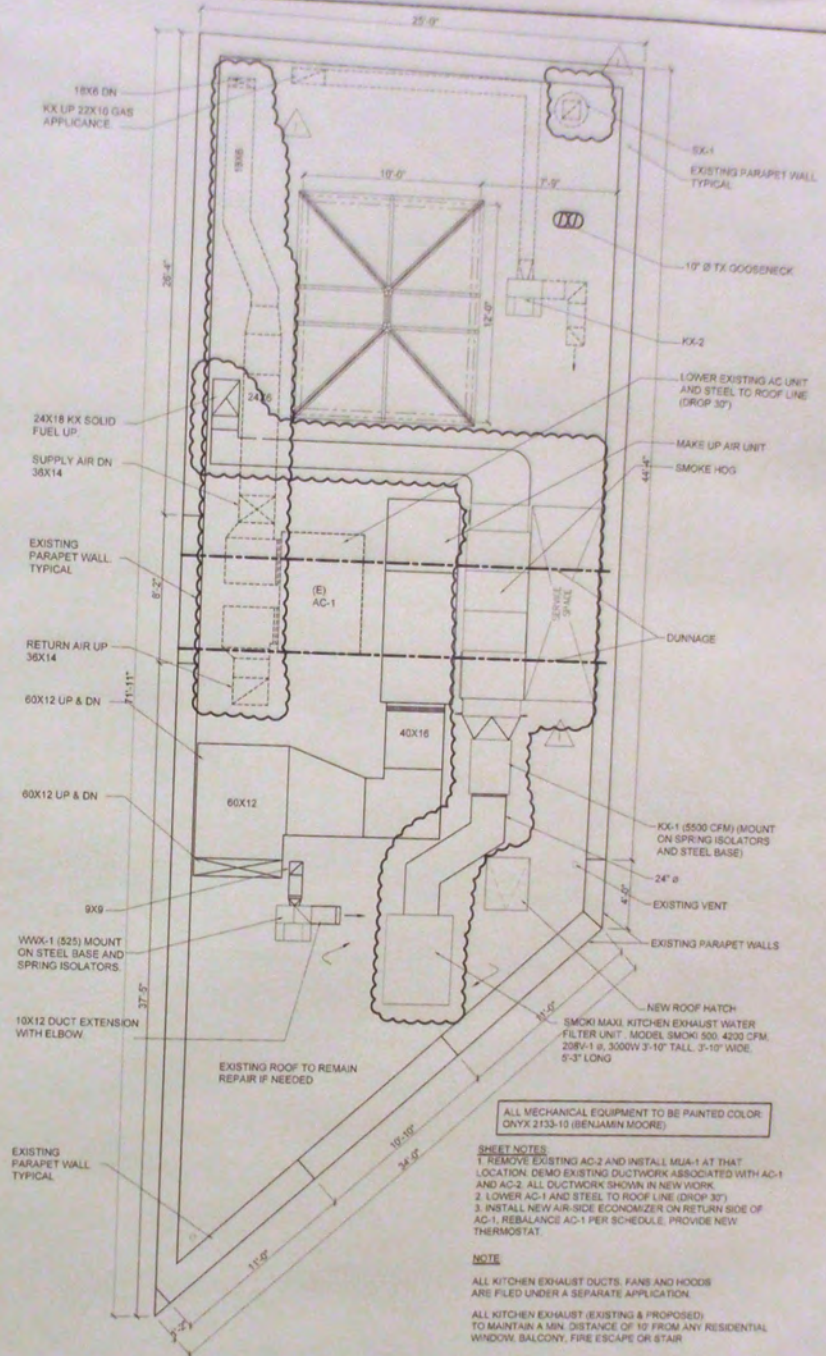

② EXISTING ROOF
SCALE: 1/4" = 1'-0"

ALL MECHANICAL EQUIPMENT TO BE PAINTED COLOR ONYX 2133-10 (BENJAMIN MOORE)

- SHEET NOTES**
- REMOVE EXISTING AC-2 AND INSTALL MJ4-1 AT THAT LOCATION. DEMO EXISTING DUCTWORK ASSOCIATED WITH AC-1 AND AC-2. ALL DUCTWORK SHOWN IN NEW WORK.
 - LOWER AC-1 AND STEEL TO ROOF LINE (DROP 30").
 - INSTALL NEW AIR-SIDE ECONOMIZER ON RETURN SIDE OF AC-1. REBALANCE AC-1 PER SCHEDULE. PROVIDE NEW THERMOSTAT.

NOTE

ALL KITCHEN EXHAUST DUCTS, FANS AND HOODS ARE FILED UNDER A SEPARATE APPLICATION.

ALL KITCHEN EXHAUST (EXISTING & PROPOSED) TO MAINTAIN A MIN. DISTANCE OF 10' FROM ANY RESIDENTIAL WINDOW, BALCONY, FIRE ESCAPE OR STAIR.

ONYX 2133-10 (BENJAMIN MOORE)
SCALE: NTS

JULY 2012
MARCH 2012
MAY 2011
APRIL 2011
ISSUE DATES:

RENOVATION
25 7TH AVENUE SOUTH
NEW YORK, N.Y. 10014

SWA
THE OFFICE OF S.W.A. ARCHITECTS
190 E. MAIN STREET
HUNTINGTON, N.Y.

A-2



LOCATION MAP

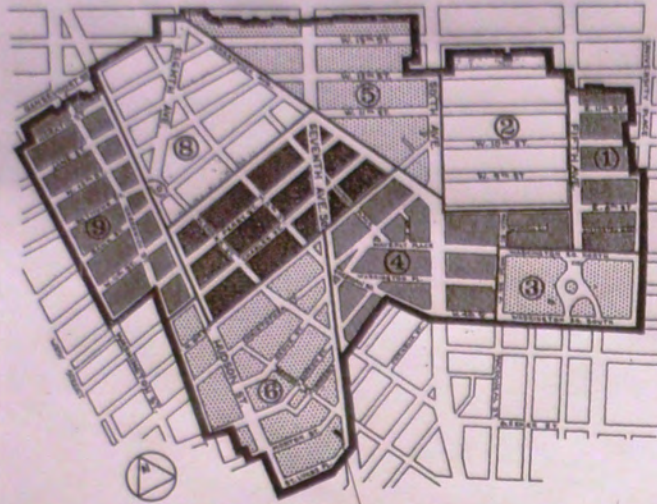

**GREENWICH VILLAGE
HISTORIC DISTRICT
MANHATTAN**

Numbered Areas relate to the text of the Commission's Designation Report.

For convenience in writing this Report, and solely for this purpose, the Greenwich Village Historic District has been arbitrarily divided into nine contiguous areas. This division into areas has no significance historically, architectural or otherwise, and has been introduced for convenience in organizing the material for this Report.

26 7TH AVENUE SOUTH

① HISTORIC DISTRICT MAP
N.T.S.



② PHOTO 1 OF PREVIOUS EXISTING CONDITIONS
N.T.S.

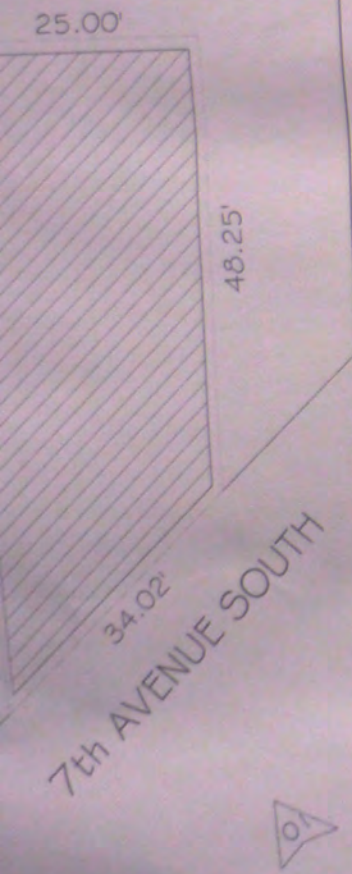

SITE MAP



③ DESIGNATION PHOTO
N.T.S.

JULY 2012
MAY 2011
APRIL 2011
ISSUE DATES:

RENOVATION
@
26 7TH AVENUE SOUTH
NEW YORK, N.Y. 10014

SWA
THE OFFICE OF S. WATSON
ARCHITECTS
190 E. MAIN STREET
HUNTINGTON, N.Y.

A-1

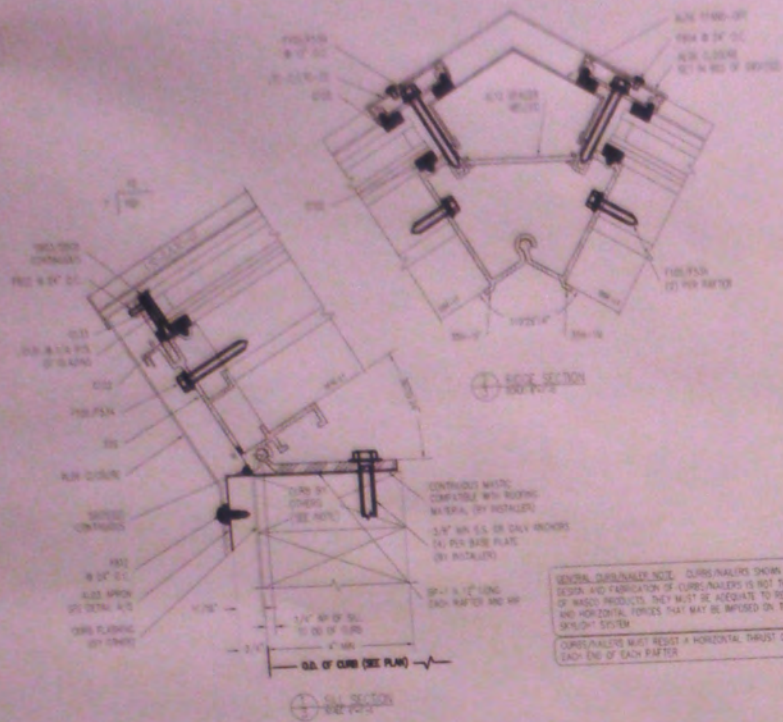

GENERAL DIMENSIONAL NOTE: CURTAINVALERS SHOWN ARE GENERIC DESIGN AND FABRICATOR OF CURTAINVALERS IS NOT THE RESPONSIBILITY OF THESE PRODUCTS. THEY MUST BE ADEQUATE TO RESIST ALL VERTICAL AND HORIZONTAL FORCES THAT MAY BE IMPROSED ON THEM BY THE SKYLIGHT SYSTEM.
CURTAINVALERS MUST RESIST A HORIZONTAL THRUST OF 1075 LB AT EACH END OF EACH PAFTER

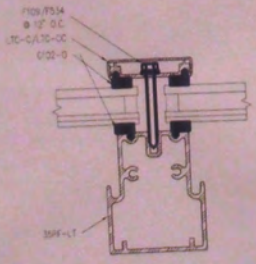
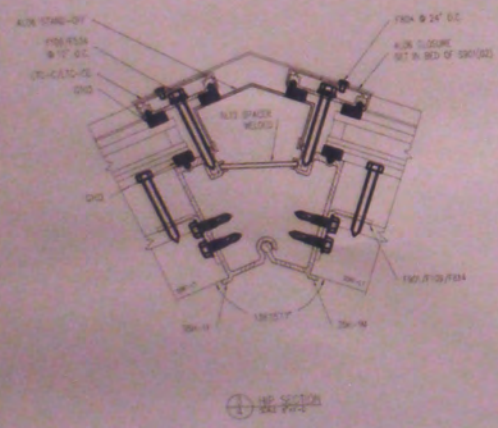

1 SKYLIGHT DETAIL
SCALE: 3/4" = 1'-0"

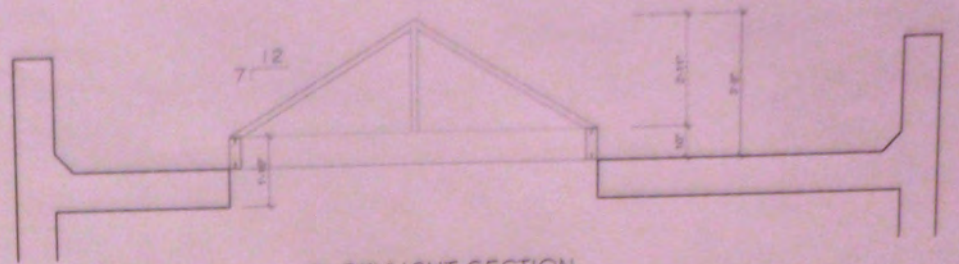

2 SKYLIGHT SECTION
SCALE: 1/2" = 1'-0"



ELEVATION -1-

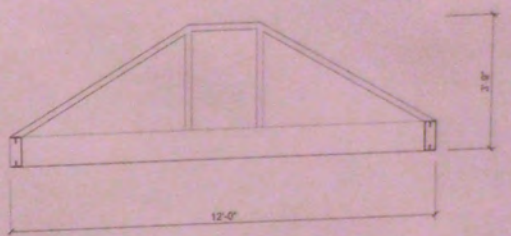

ELEVATION -2-

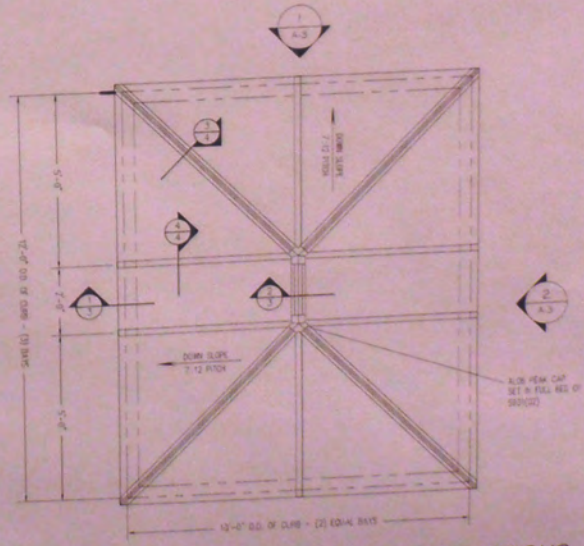

3 SKYLIGHT PLAN & ELEVATIONS
SCALE: 1/2" = 1'-0"

JULY 2012
MAY 2011
APRIL 2011
ISSUE DATES:

RENOVATION
@
28 7TH AVENUE SOUTH
NEW YORK N.Y. 10014

SWA
The Office of S. Steven Whitson
190 E. MAIN STREET
HUNTINGTON, N.Y.

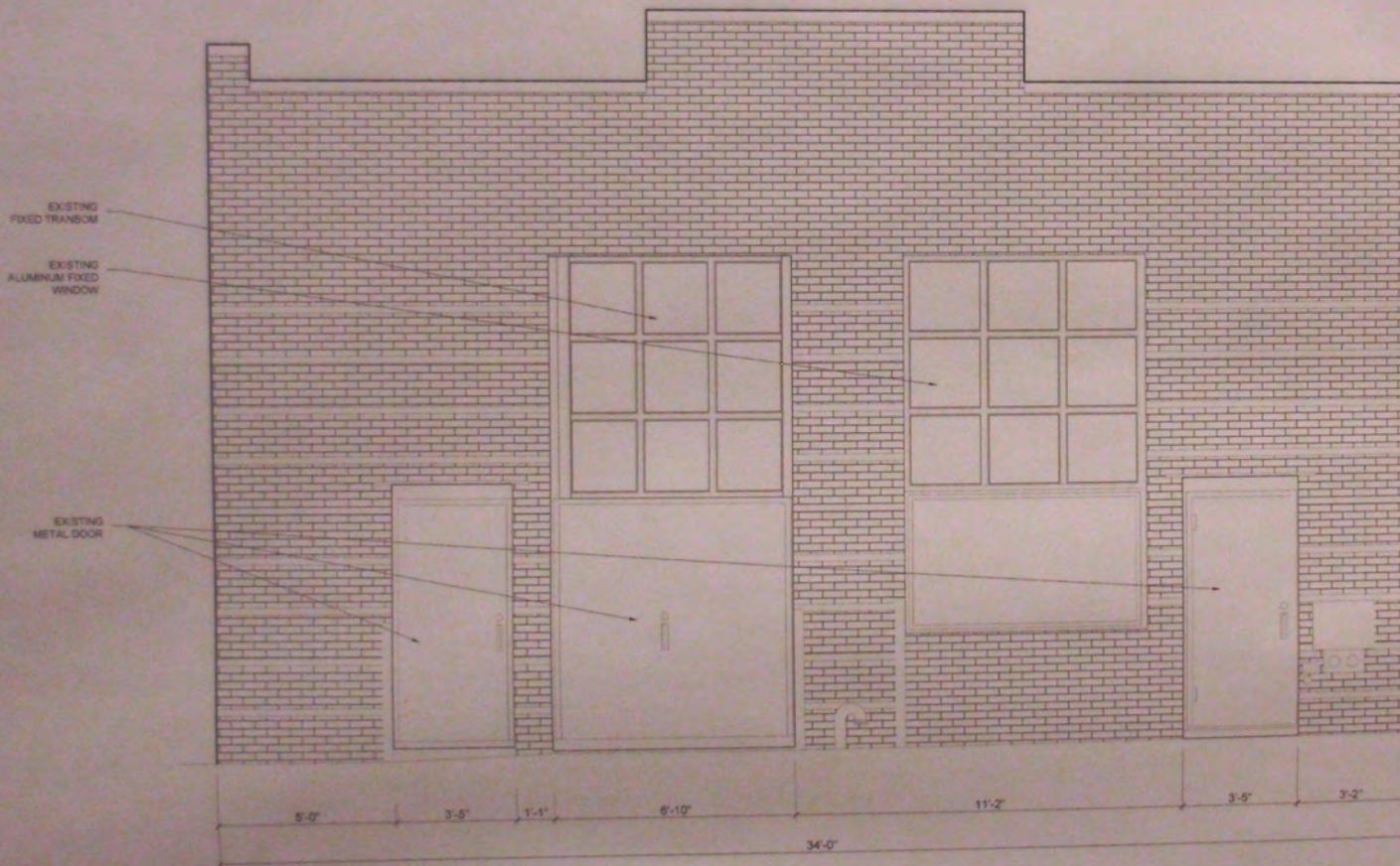
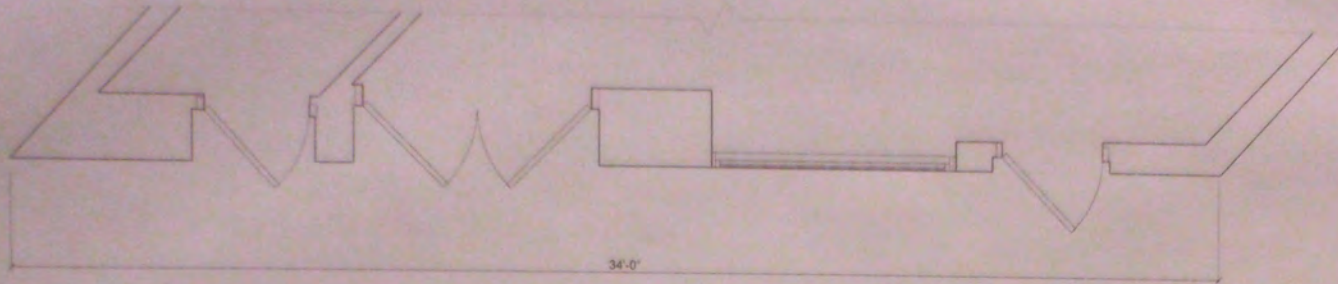

PHOTOS OF PREVIOUS
 ② EXISTING CONDITIONS
 SCALE: NOT TO SCALE

JULY 2012
 MAY 2011
 APRIL 2011
 ISSUE DATES:

RENOVATION
 @
 28 7TH AVENUE SOUTH
 NEW YORK, N.Y. 10014

SWA
 THE OFFICE OF S. EDWIN WOODS
 ARCHITECTS P.C. 190 E. MAIN STREET
 HUNTINGTON, N.Y.

AM

① PREVIOUS EXISTING ELEVATIONS
 SCALE: 1/4" = 1'-0"