

1 PLOT PLAN
SCALE: 1/8" = 1'-0"

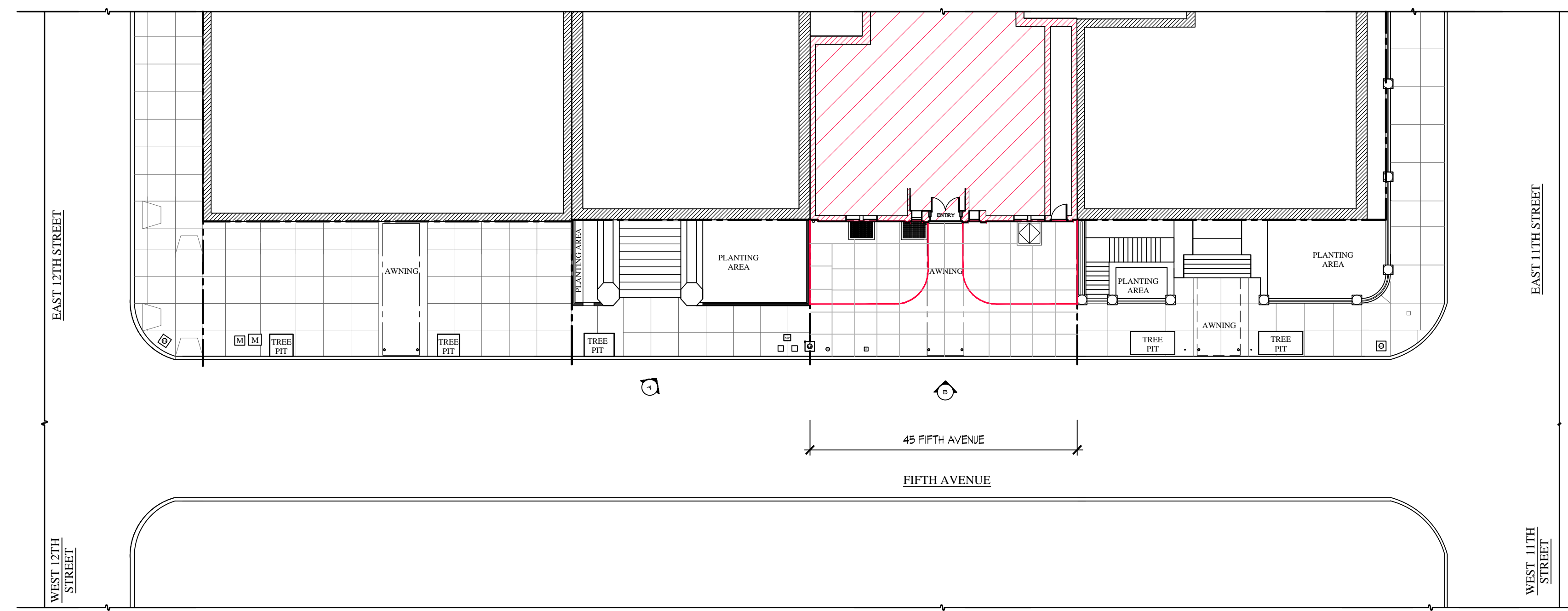

2 STREET PLAN
SCALE: 1/16" = 1'-0"



A POTENTIAL REDESIGN REFERENCE



B PHOTO A: LOOKING EAST

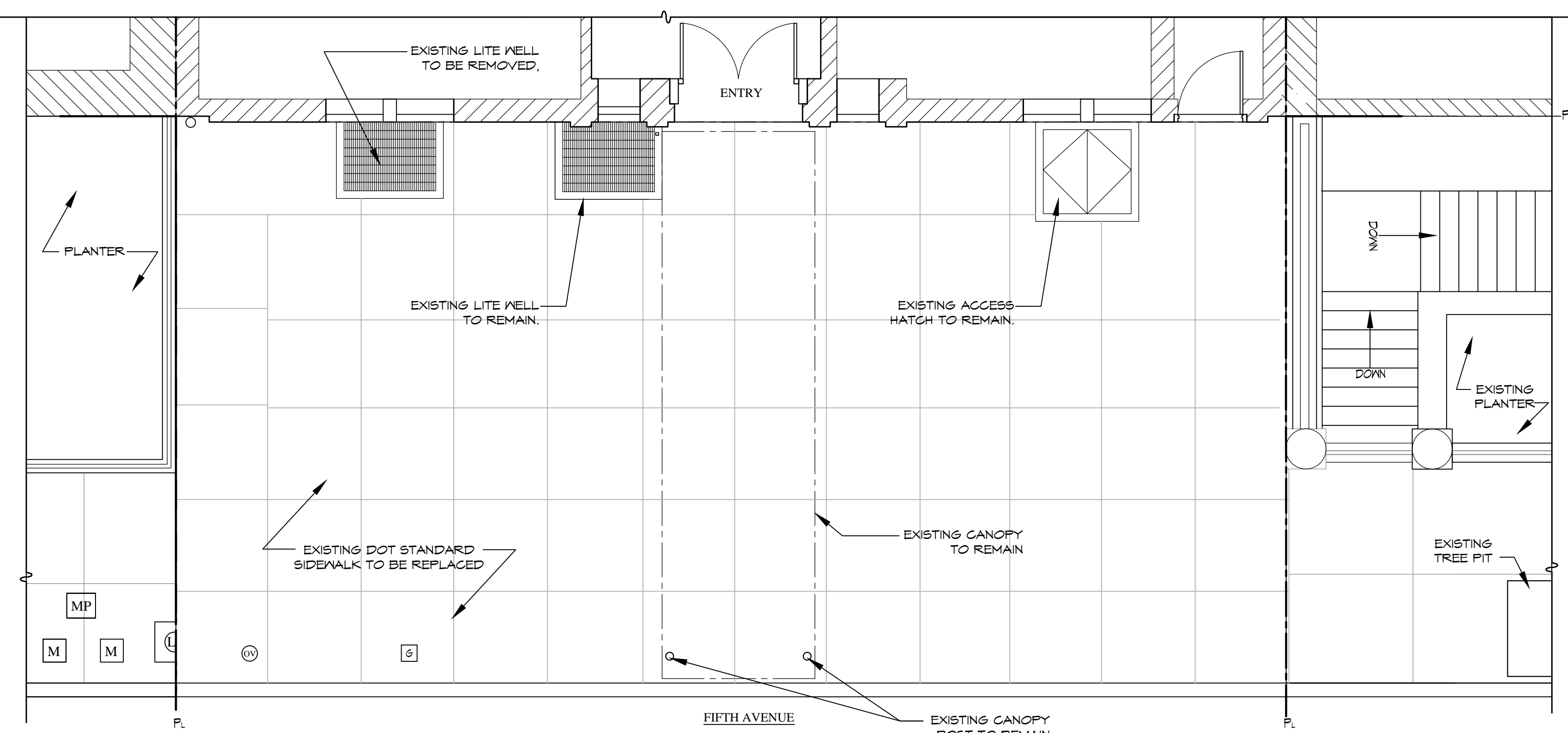

3 EXISTING SIDEWALK PLAN
SCALE: 1/4" = 1'-0"

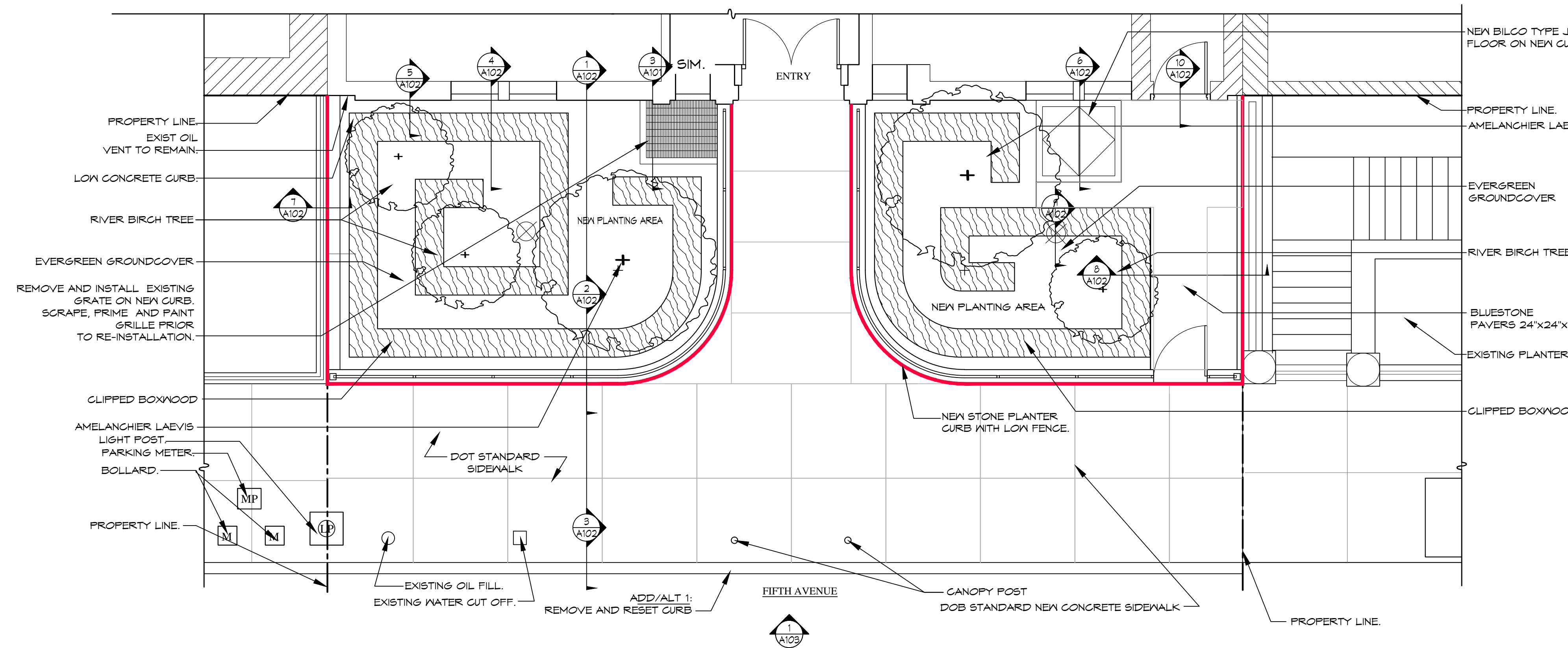
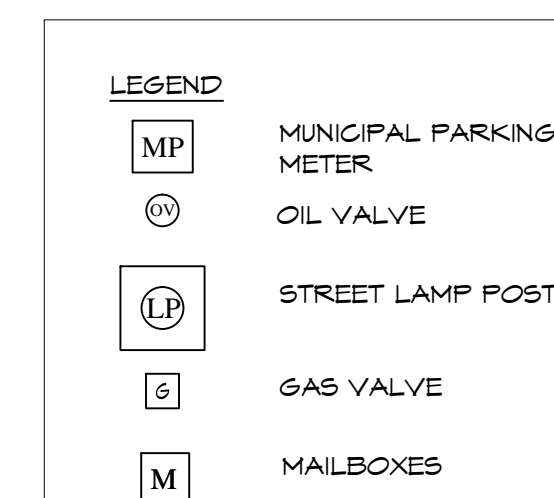

4 PROPOSED SIDEWALK PLAN
SCALE: 1/4" = 1'-0"

45 FIFTH AVENUE, NEW YORK, NY
FIFTH AVENUE GREEN SPACE SURVEY

SCALE: N.T.S. PROJECT NO. 153601
DATE: MARCH 2015
TITLE: STREET SURVEY - 5TH AVENUE WASH. SQ. NO. TO 10TH ST

ALL DRAWINGS AND INSTRUMENTAL APPROVALS ARE THE PROPERTY OF WALTER B. MELVIN ARCHITECTS, LLC. NO PART OF THIS DRAWING IS TO BE REPRODUCED OR TRANSMITTED IN ANY FORM OR BY ANY MEANS, ELECTRONIC OR MECHANICAL, INCLUDING PHOTOCOPYING, RECORDING, OR BY ANY INFORMATION STORAGE AND RETRIEVAL SYSTEM.

A100.00



1 PROPOSED STREET FACADE
SCALE 3/8" = 1'-0"

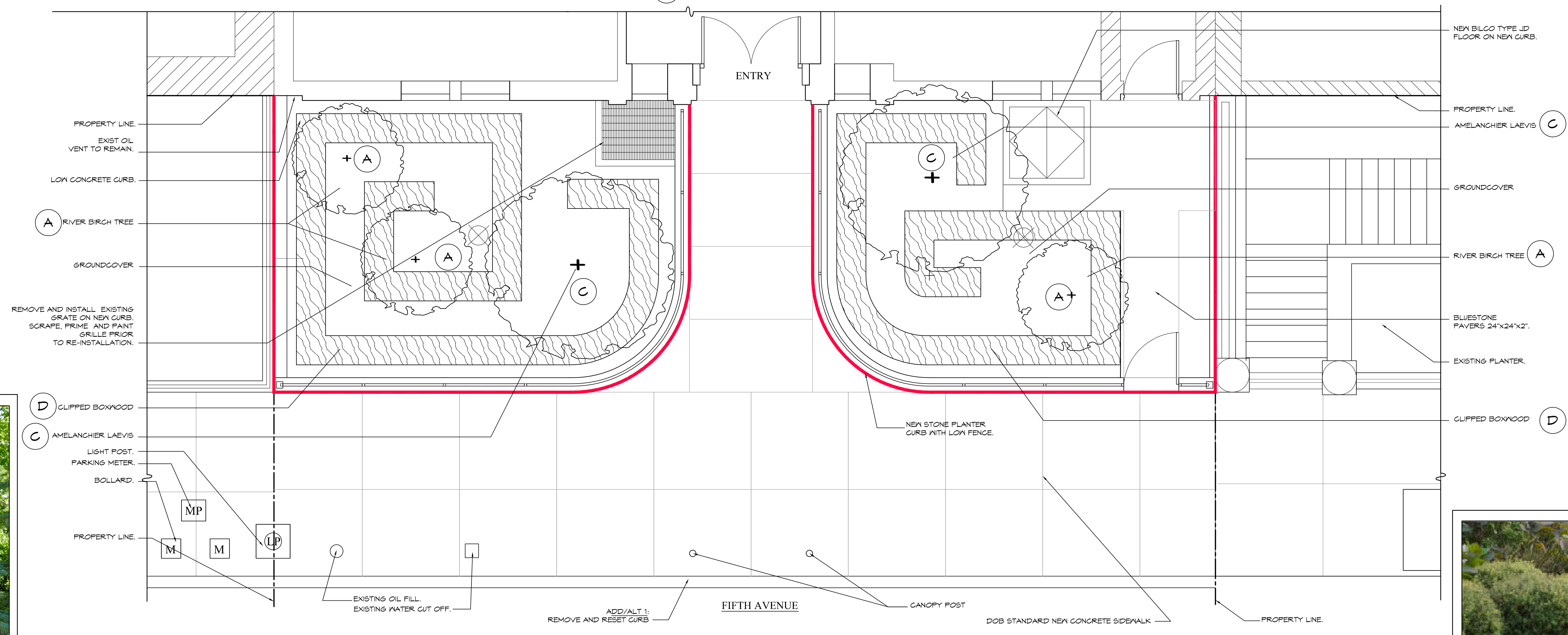

2 PROPOSED PLAN
SCALE 3/8" = 1'-0"

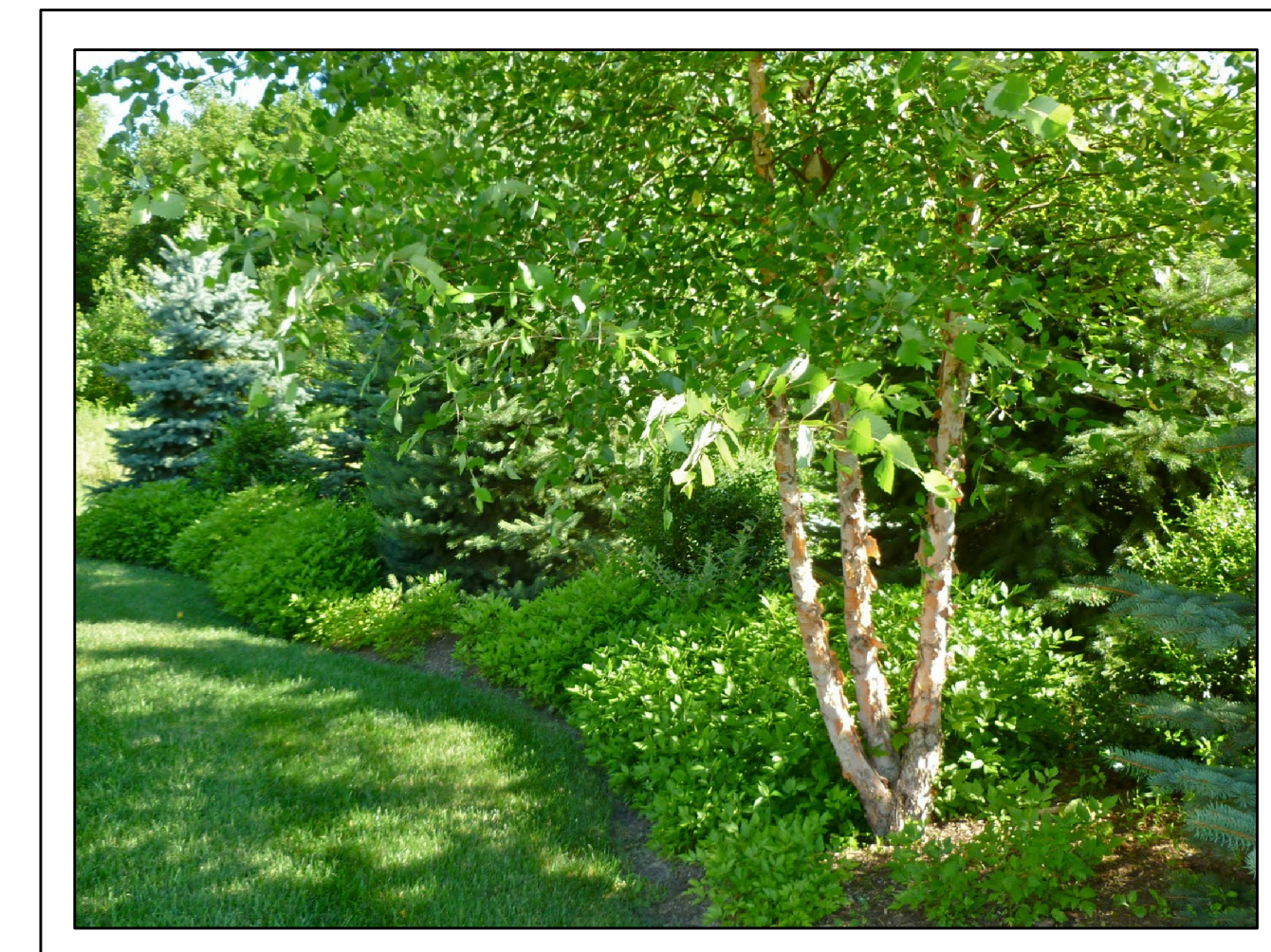

A RIVER BIRCH



B RIVER BIRCH



C AMELANCHIER LAEVIS

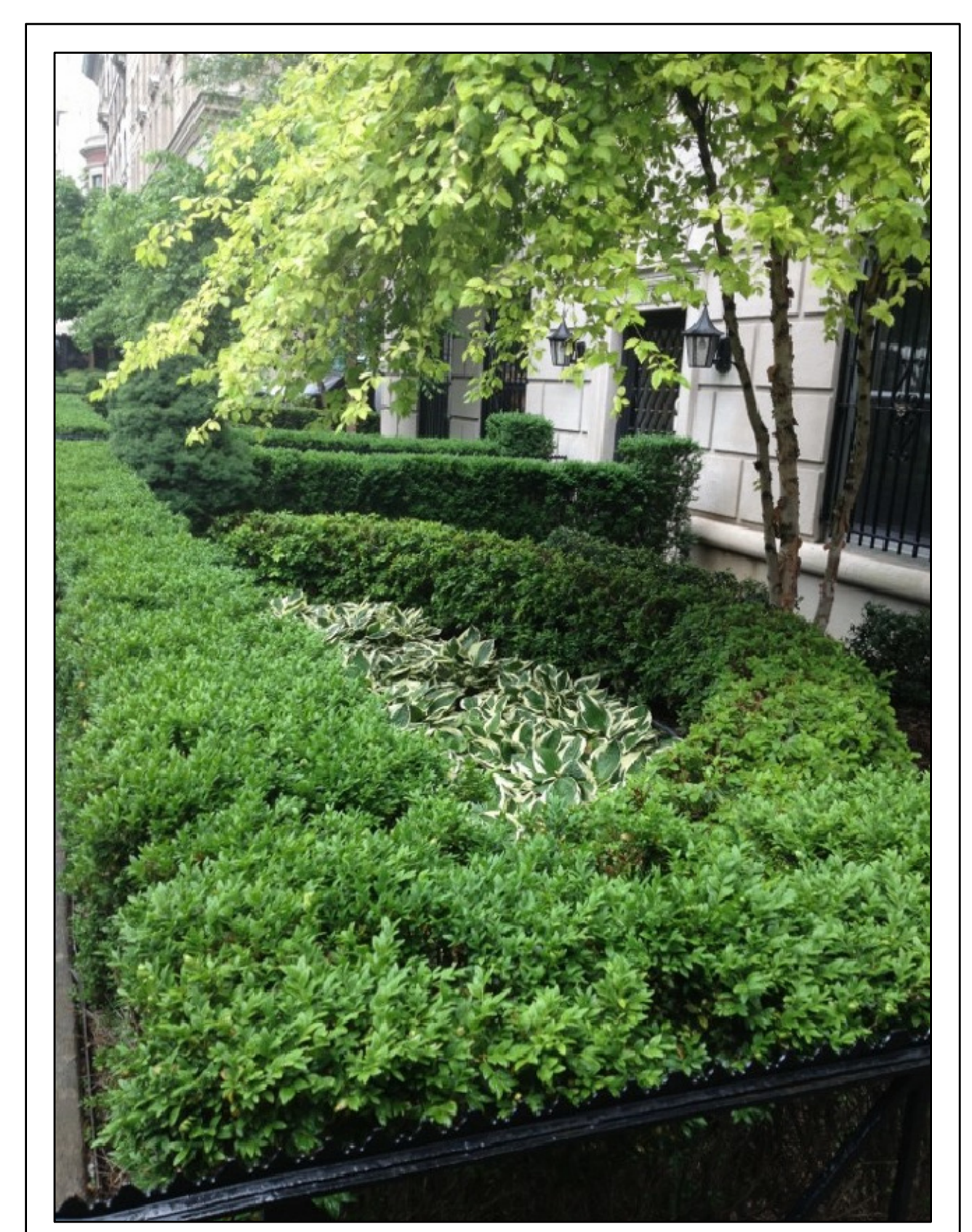

D CLIPPED BOXWOOD



E NARCISSUS JETTFIRE

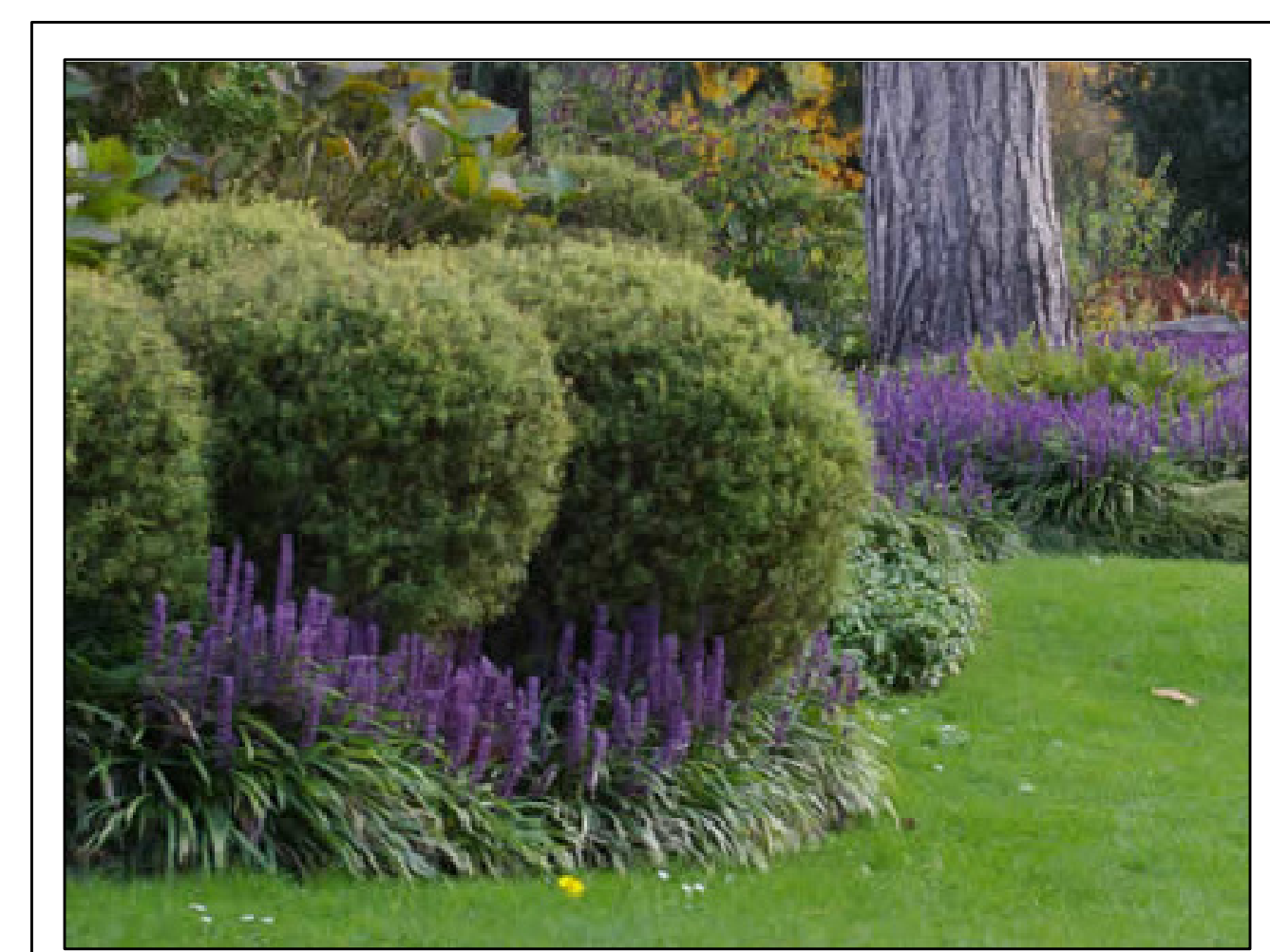

F LIRIOPE MUSCARI



G LIRIOPE MUSCARI

45 FIFTH AVENUE, NEW YORK, NY
FIFTH AVENUE GREEN SPACE SURVEY

SCALE: PROJECT NO:
N.T.S. 153601
DRAWN BY: DATE:
BAB MARCH 2015
TITLE:
STREET SURVEY -
5TH AVENUE WASH.
SQ. NO. TO 10TH ST
SCL. 1/8"=1'-0"

A101.00

DATE	DESCRIPTION

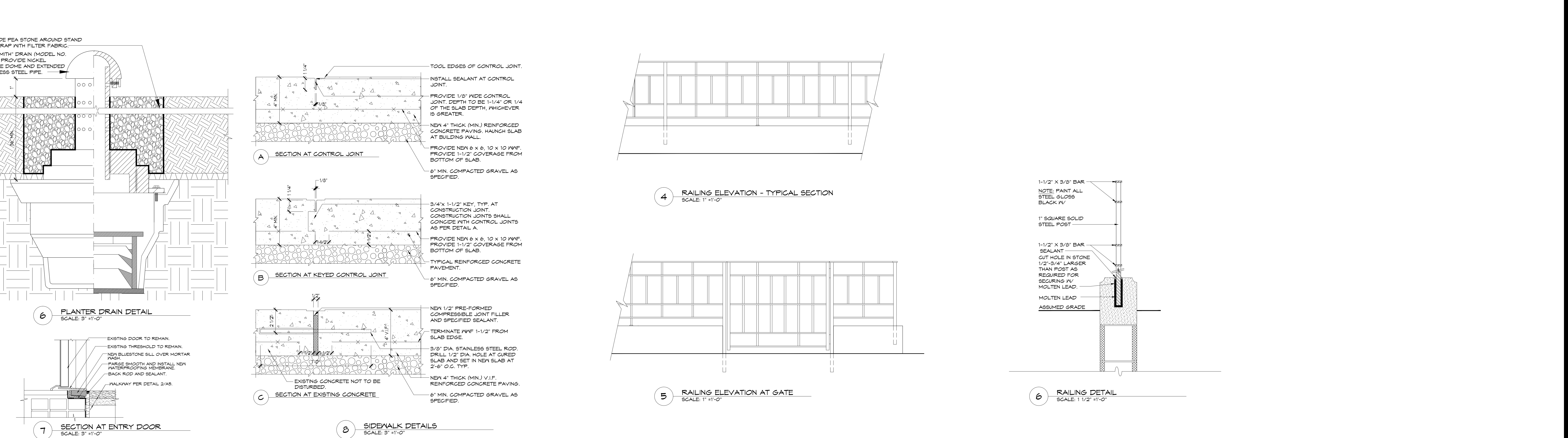
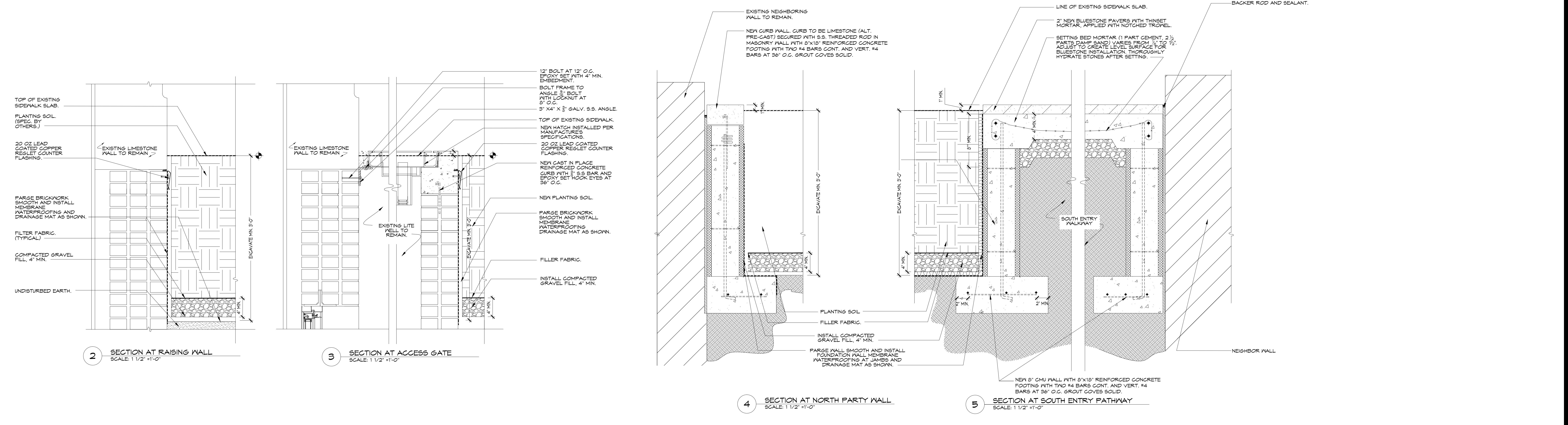
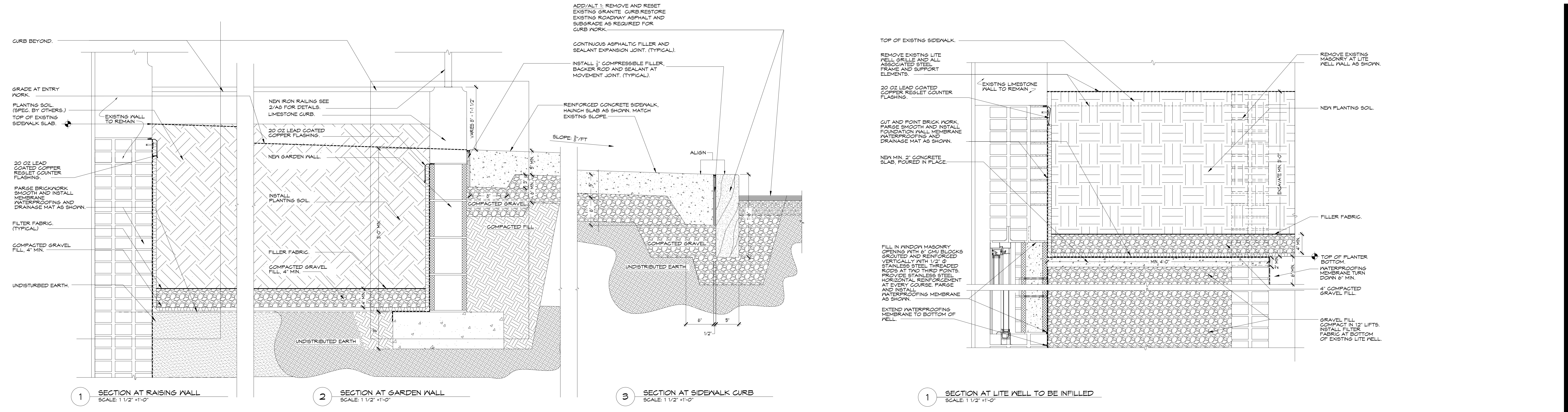

45 FIFTH AVENUE, NEW YORK, NY
 FIFTH AVENUE GREEN SPACE SURVEY

PROJECT: N.T.S. 153601
 DRAWN BY: BAB
 DATE: MARCH 2015
 TITLE: STREET SURVEY - 5TH AVENUE W/ASH. SQ. NO. TO 10TH ST
 SCALES: 1/8" = 1'-0"

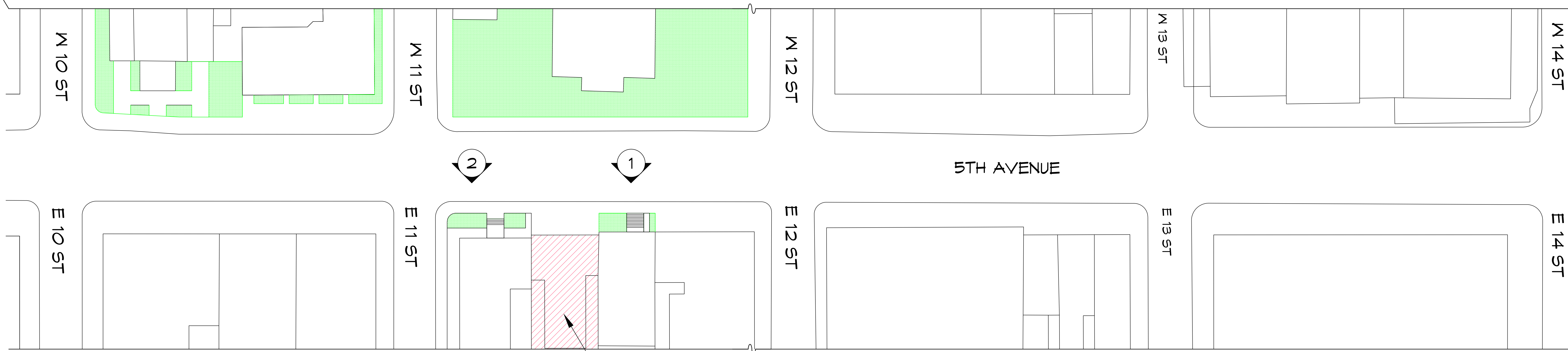

A FIFTH AVENUE: 10TH STREET TO 14TH STREET
N.T.S.

45 FIFTH AVENUE



1 47 FIFTH AVENUE



2 43 FIFTH AVENUE

45 FIFTH AVENUE, NEW YORK, NY

FIFTH AVENUE GREEN SPACE SURVEY

SCALE: PROJECT NO:
N.T.S. 153601
DRAWN BY: DATE:
BAB MARCH 2015
TITLE:
STREET SURVEY -
5TH AVENUE
10TH ST TO 14TH ST.
SHEET NUMBER:

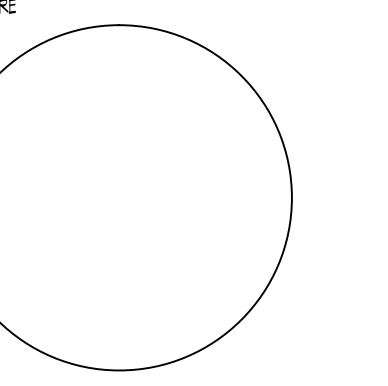

ALL DRAWINGS AND NOTATIONS ARE THE PROPERTY OF WALTER B. MELVIN ARCHITECTS, LLC. NO PART OF THIS DOCUMENT IS TO BE REPRODUCED OR TRANSMITTED IN ANY FORM OR BY ANY MEANS, ELECTRONIC OR MECHANICAL, INCLUDING PHOTOCOPYING, RECORDING, OR BY ANY INFORMATION STORAGE AND RETRIEVAL SYSTEM, WITHOUT THE WRITTEN PERMISSION OF WALTER B. MELVIN ARCHITECTS, LLC.

PH-01

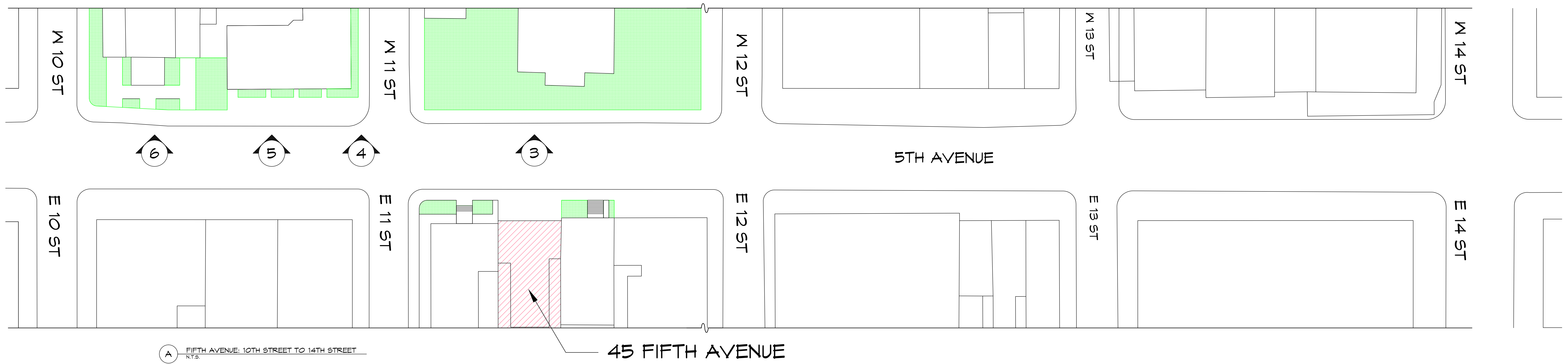

A FIFTH AVENUE: 10TH STREET TO 14TH STREET
N.T.S.

45 FIFTH AVENUE



3 12 WEST 12TH STREET



4 40 FIFTH AVENUE



5 40 FIFTH AVENUE



6 36 FIFTH AVENUE



45 FIFTH AVENUE, NEW YORK, NY

FIFTH AVENUE GREEN SPACE SURVEY

PROJECT: _____
 SCALE: N.T.S. PROJECT NO: 153601
 DRAWN BY: BAB DATE: MARCH 2015
 TITLE: STREET SURVEY -
 5TH AVENUE
 10TH ST TO 14TH ST.
 BILLBOARD: _____

ALL DRAWINGS AND NOTATIONS ARE THE PROPERTY OF WALTER B. MELVIN ARCHITECTS, LLC. NO PART OF THIS DOCUMENT IS TO BE REPRODUCED OR TRANSMITTED IN ANY FORM OR BY ANY MEANS, ELECTRONIC OR MECHANICAL, INCLUDING PHOTOCOPYING, RECORDING, OR BY ANY INFORMATION STORAGE AND RETRIEVAL SYSTEM, WITHOUT THE WRITTEN PERMISSION OF WALTER B. MELVIN ARCHITECTS, LLC.
 DRAWING NO: PH-02

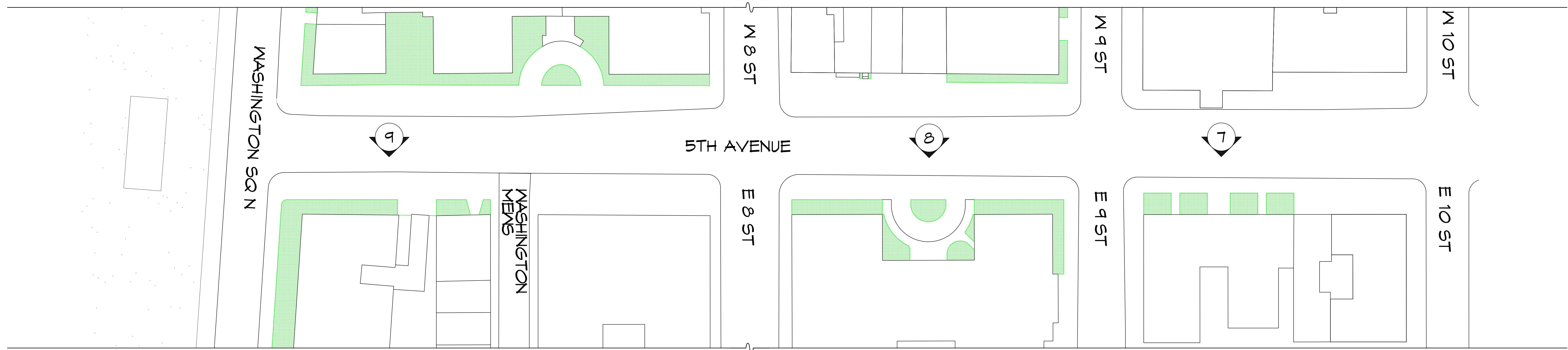

A FIFTH AVENUE: WASHINGTON SQUARE NORTH TO 10TH STREET
N.T.S.



7 25 FIFTH AVENUE



8 9 FIFTH AVENUE



9 1 1/2 FIFTH AVENUE



45 FIFTH AVENUE, NEW YORK, NY

FIFTH AVENUE GREEN SPACE SURVEY

PROJECT: _____
SCALE: N.T.S. PROJECT NO: 153601
DRAWN BY: BAB DATE: MARCH 2015
TITLE: STREET SURVEY -
5TH AVENUE WASH.
SQ. NO. TO 10TH ST
SHEET NUMBER: _____

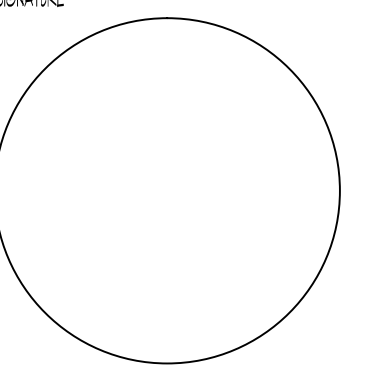

ALL DRAWINGS AND NOTATIONS ARE THE PROPERTY OF WALTER B. MELVIN ARCHITECTS, LLC. NO PART OF THIS DOCUMENT IS TO BE REPRODUCED OR TRANSMITTED IN ANY FORM OR BY ANY MEANS, ELECTRONIC OR MECHANICAL, WITHOUT THE WRITTEN PERMISSION OF WALTER B. MELVIN ARCHITECTS, LLC.

DRAWING NO: PH-03

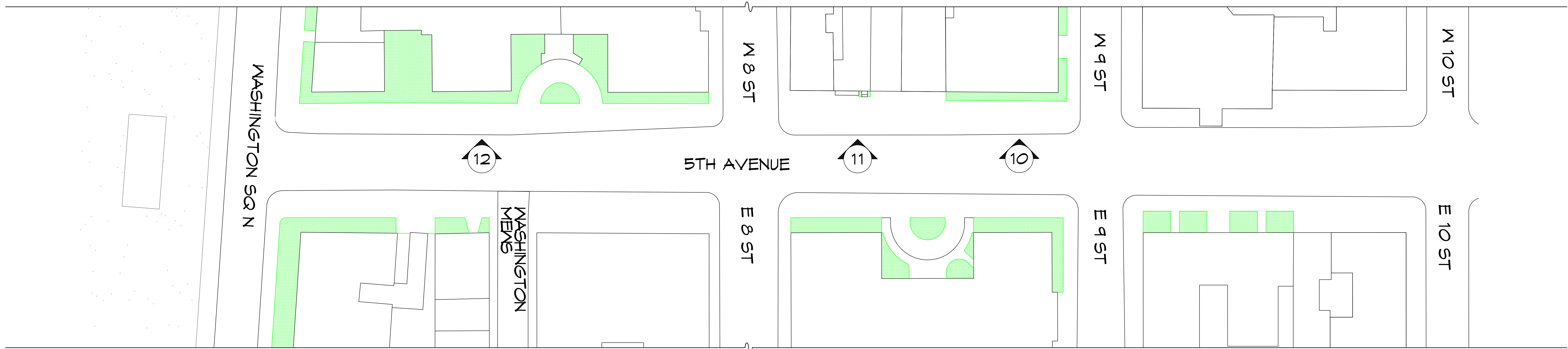

A FIFTH AVENUE: WASHINGTON SQUARE NORTH TO 10TH STREET
N.T.S.



10 20 FIFTH AVENUE



11 12 FIFTH AVENUE



12 2 FIFTH AVENUE



45 FIFTH AVENUE, NEW YORK, NY

FIFTH AVENUE GREEN SPACE SURVEY

PROJECT: _____
 SCALE: N.T.S. PROJECT NO: 153601
 DRAWN BY: BAB DATE: MARCH 2015
 TITLE: STREET SURVEY -
 5TH AVENUE WASH.
 SQ. NO. TO 10TH ST
 SCALE: 1/8"=1'-0"

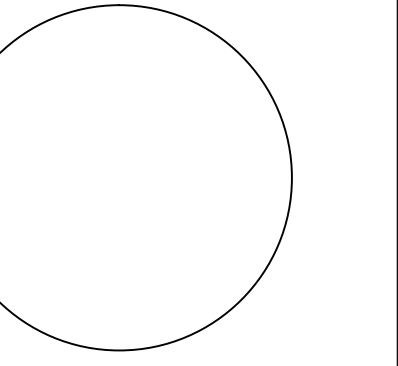

ALL DRAWINGS AND NOTATIONS ARE THE PROPERTY OF WALTER B. MELVIN ARCHITECTS, LLC. NO PART OF THIS DOCUMENT IS TO BE REPRODUCED OR TRANSMITTED IN ANY FORM OR BY ANY MEANS, ELECTRONIC OR MECHANICAL, INCLUDING PHOTOCOPYING, RECORDING, OR BY ANY INFORMATION STORAGE AND RETRIEVAL SYSTEM, WITHOUT THE WRITTEN PERMISSION OF WALTER B. MELVIN ARCHITECTS, LLC.

DRAWING NO: PH-04